

EXISTING HOUSE

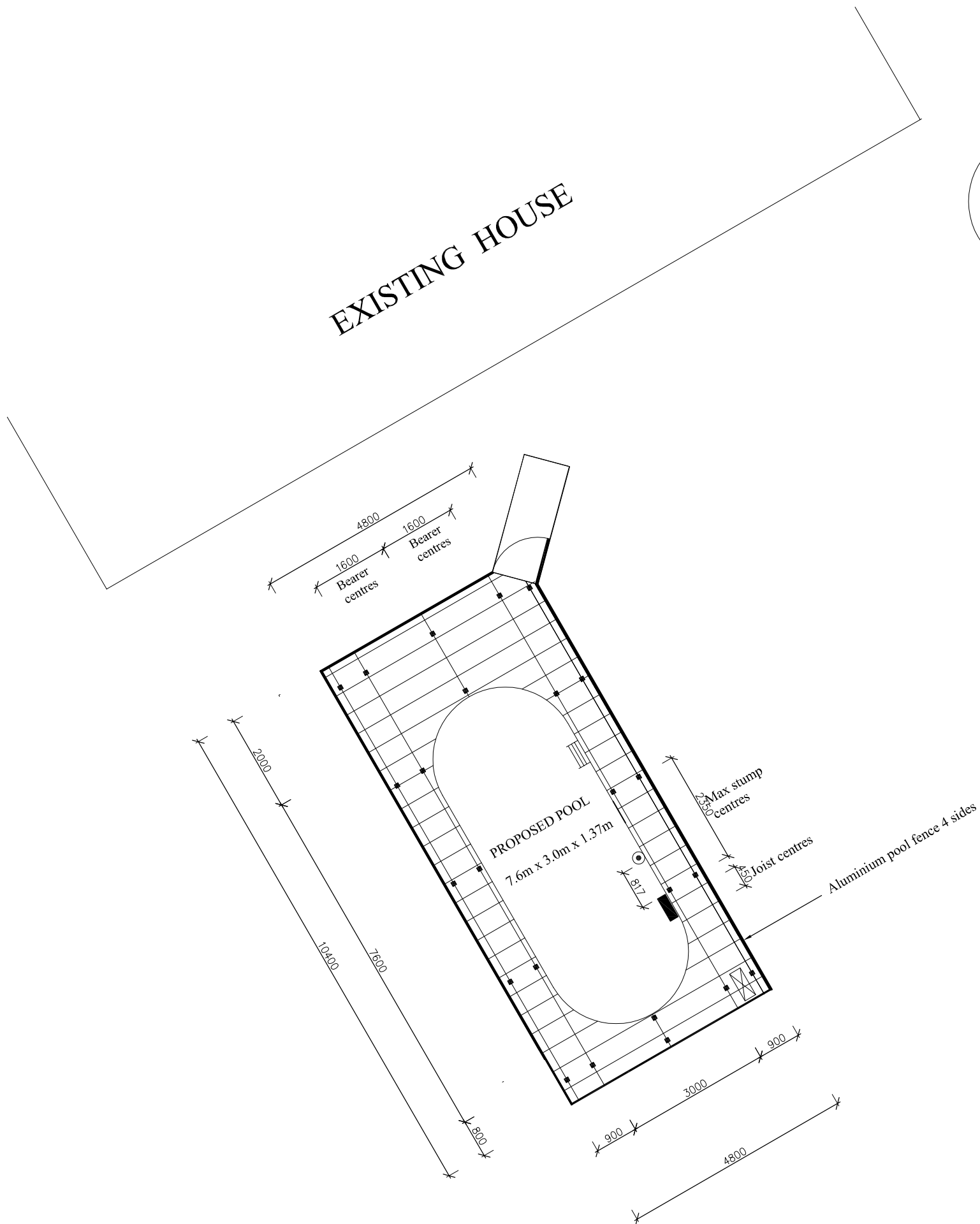
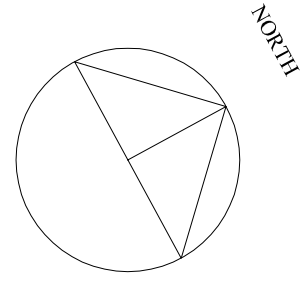

## NOTES :-

### DECK - construction details:-

Stumps : - 90/90 H4 treated pine

@ 800-2350 mm centres. Braced with 30mm x 1mm galvanised punched bracing where required.

Concrete pier footing : 600 x 400 dia reinforced concrete footings..

Bearers: 140/45 H3 Treated Pine @ max 1600mm centres

Bearer fixings : M10/120mm galv Cup head bolts .

Joists: 90/45mm H3 Treated Pine @450mm centres.

Joist fixings : triple grip joist ties , 3 x 40mm galv clouts, and 3.06 x 75mm galv. dipped framing nails.

Decking boards: 86 mm x 19mm Blackbutt. 3mm nominal spacings.

Deck fixings: 50mm x 2.5mm stainless steel nails.

### POOL FENCING:





Aluminium pool fencing : 2450 X 1200 aluminium flat panel AS 1926.1-2007 ( black.), Fixed to 2 x 90/45 treated pine studs fixed to deck sub-frame using 14g x 100mm batten screws. 975 mm single access gate opening outwards. Magna safety latch fitted at 1500mm above deck FF level. Max. 70mm clearance between bottom rail and deck FF level. Compliant with 900mm non climbable zone surrounding pool safety barrier.

### Pump and Filtration:

to be located under deck . Refer layout sketch.

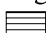
Pool : Sterns Bahama 7.6m x 3m x 1.37m salt water oval pool ( see engineers certificates ). Backfilled with 6% cement treated sand & ag. drainage system as per manufacturers specifications. 3 step stainless steel ladder.

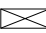
### Legend

-  Stainless steel pool ladder
-  Second Safety suction point ( 800mm from skimmer box suction )
-  Pump and Cartridge filter location
-  Skimmer box

**diglandscape**  
Design & Construction

ph. 0431 961 579  
diglandscape@adam.com.au

Client A. Miller & J. Ash

DECK DETAILS

DATE 3.11.14 SCALE - 1 : 100

SITE - 22 LEE ST EDEN HILLS

Drg No DIG. LEE/MA SHt 3 of 4

REVISION A  
11.12.14